

OPENRUN PRO 2

PREMIUM BONE CONDUCTION SPORT HEADPHONES

The new Shokz OpenRun Pro 2 provides astounding sound quality for sports enthusiasts, delivering up to 12 hours of unmatched audio. Equipped with wind-resistant microphones and a premium nickel-titanium frame, it ensures crystal-clear phone conversations even in extremely windy conditions. Additionally, its comfortable and secure fit offers peace of mind during use.



RRP: \$179.95 USD

FEATURES

- DualPitch Technology for superior sound
- Open-ear design for safety
- Optimized fit for maximum comfort
- Crystal Clear Voice
- Waterproof USB-C for safe, easy charging
- 12 hours of playtime for prolonged listening
- 5-minute quick charge for 2.5 hours of music
- Shokz App
- Two Sizes for a Seamless Fit

COLOR



WHAT'S IN THE BOX

- OpenRun Pro 2 headphone
- Carrying bag
- USB-C charging cable
- After-sales service card
- User guide

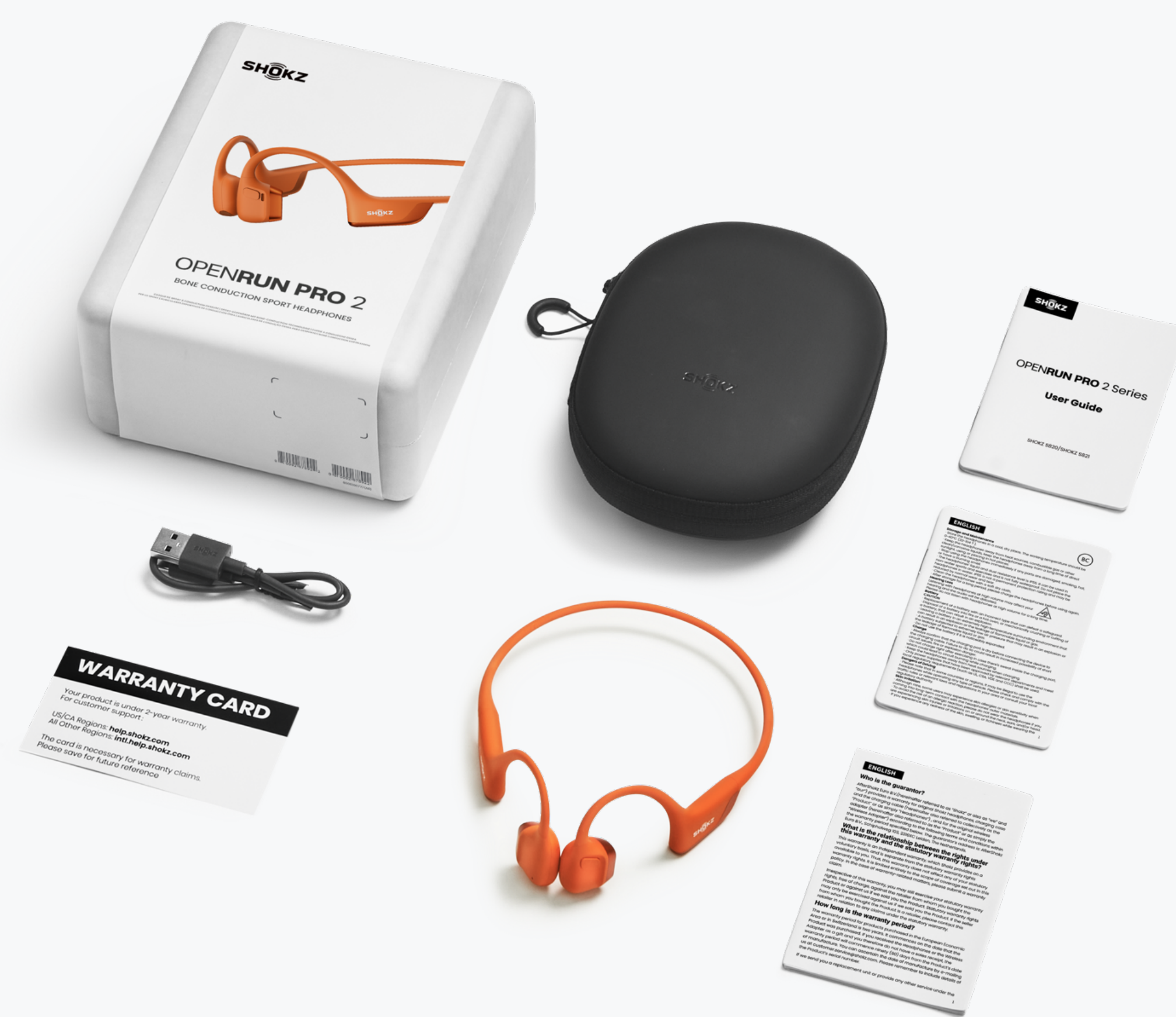

SPECIFICATIONS

Part number	Standard: SHOKZ S820 Mini: SHOKZ S821
Speaker type	Air conduction speaker Bone conduction speaker
Frequency response	20Hz-20KHz
Speaker sensitivity	Air conduction speaker: 96dB±2.5dE Bone conduction speaker: 101.3dB±3
Microphone sensitivity	-38dB ±1dB
Bluetooth® version	Bluetooth® V5.3
Compatible profiles	A2DP,AVRCP,HFP
Materials	headphone : Full Titanium , Silicone, plastic, nickel-titanium alloy
Charge voltage	5V±5%
Frequency band	2400-2483.5MHz
Wireless range	33ft (10m)

Battery	Li-Polymer battery
Continuous play	Up to 12 hours of listening time with a single charge ¹
Standby time	Up to 10 days
Charge time	Charge the headphone : 60 minutes ²
Quick charge	A 5-minute charge gives 2.5 hour of battery life (music) ³
Weight	Standard: 30.3±0.5g Min: 30±0.3g ⁴
Warranty	2 years
Sweat resistance	headphone : IP55
Battery capacity	headphone: 150mAh/0.581Wh
Audio codecs supported	SBC

PACKAGING DIMENSIONS

Carton	Length	Width	Height	Cube	Net weight	Gross weight
Single (1)	16.75cm	13.6cm	7.5cm	1708.5 cm ³	0.145kg±0.001kg	0.338kg±0.005kg
Master (16)	34.3cm	38.5cm	30.5cm	40276.775 cm ³	2.32kg	6.808kg±0.02kg
Master (24)	48.75cm	30cm	36.75cm	53746.875 cm ³	3.475kg	8.824kg±0.02kg

1. This music endurance data was gathered at the Shokz Laboratory in a temperature-controlled environment of 25±2 °C, playing SBC-encoded audio at a 75% volume and all other features set to default. The actual battery life depends on the volume, sound source, degree of environmental interference, product features, use habits, and other factors.
 2. The data is from Shokz Laboratory in a temperature-controlled environment of 25±2 °C. The actual battery life depends on the volume, sound source, degree of environmental interference, product features, use habits, and other factors.
 3. The quick charge data was gathered at the Shokz Laboratory in a temperature-controlled environment of 25±2 °C. By default, if you charging the headphone for 5 minutes, you can play SBC mode audio at 75% volume for 150 minutes. The actual battery life after a charging is affected by volume, audio source, degree of environmental interference, product features, and use habits
 4. Affected by product configuration and manufacturing process, the actual weight of the product may vary. Please refer to the real object.